

Universal light-duty plastic anchor with multidirectional expansion for use on concrete, solid masonry, hollow masonry brick and hollow concrete block

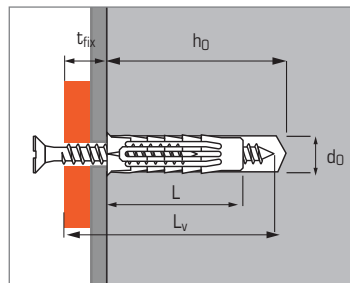

APPLICATIONS

- Pipe fasteners for electrical systems
- Fixing of light cable trays and junction boxes
- Lighting system fixings
- Fixing of drywall guides
- Boilers, convector heaters
- Fixing of sanitary accessories
- Furniture

MATERIAL

Versioni POZIDRIV :



/VA: countersunk flat head screw



/VN: countersunk pan head screw



/VX: pan head flanged screw



/VKC: pan head flanged screw; long pitch thread

- Expansion body in polyamide, color gray (RAL 7035), halogen-free.
- Cylindrical screws, with electrolytic galvanizing (Cr3+) and thickness $\geq 5 \mu\text{m}$, with screw head in pozidriv (VA, VN, VX, VKC) or hexagonal (VTE R).

INSTALLATION TEMPERATURE

Installation temperature:

-5°C ÷ +40°C

Working temperature:

-40°C ÷ +80°C

Technical Data

Anchor size	Ø screw thread (mm) d _v min÷ max	Screw length (mm) L _v	Max. Fixable thickness (mm) t _{fix}	Drilling min. depth* (mm) h ₀	Code	
					Body version	
5x25	3 ÷ 4	30	2	35	565385	
6x30	4 ÷ 5	35	5	40	565386	
6x45	4 ÷ 5	50	5	55	565757	
8x40	4,5 ÷ 6	45	5	55	565387	
8x50	4,5 ÷ 6	55	5	65	565758	
10x50	6 ÷ 8	55	5	65	565388	
10x60	6 ÷ 8	65	5	75	565759	
12x60	8 ÷ 10	65	5	75	565281	
14x70	10 ÷ 12	75	5	90	565282	

Anchor size	Screw measure (mm) d _v x L _v	Max. Fixable thickness (mm) T _{fix}	Drilling min. depth* (mm) h ₀	Code			
				version with screw			
				VA	VN	VX	VKC
5x25	4x30	2,0	30	565389	-	-	-
6x30	4,5x40	5,0	35	565390	565393	565395	568686
6x45	4,5x60	5,0	55	565882	-	-	-
8x40	5x50	5,0	45	565391	-	-	-
8x50	5x60	5,0	55	565883	-	-	-
10x50	6x50	5,0	55	565392	-	-	-
10x60	6x70	5	65	565884	-	-	-

Values for T6 installed with the screws provided in the combo packs

Anchor size	Screw measure (mm) d _v x L _v	Max. Fixable thickness (mm) T _{fix}	Drilling min. depth* (mm) h ₀	Code	
				version with screw	
				VTE R	
10x50	7x70	5,0	65	565761	
12x60	8x80	15,0	75	565762	
14x70	10x100	20,0	90	565763	

* The drilling depth refers to the maximum thickness that can be fixed and the minimum length of the screw.

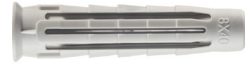

Universal light-duty plastic anchor with multidirectional expansion for use on concrete, solid masonry, hollow masonry brick and hollow concrete block

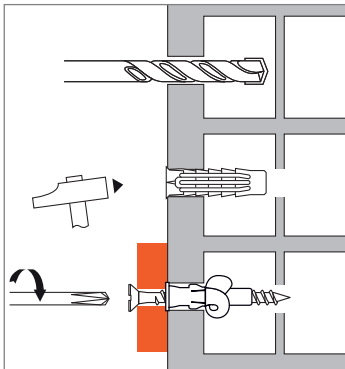
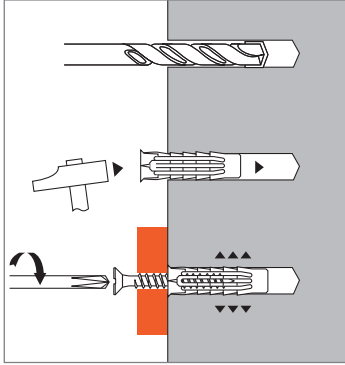
INSTALLATION
Solid masonry:

Drilling:

Drill with the diameter hole prescribed (d0) and length hole at least equal to the depth h0. In the hollow brick not plastered, take care of the definition of the hole, not strongly chipped or embrittled. Where necessary, drilling in rotation only.

Installation and expansion:

Insert completely the anchor into the hole. Screw up to bring the screw head in contact with the part to be fixed. Keep rotating until a consistent tightening. Tighten the screw until you reach a satisfactory locking of the part to fix. Use manual screwdriver or electric screwdriver equipped by torque regulator and recommended rotation speed within 500 days/min. Adjust the electric screwdriver in order to avoid the rotation of the screw.

TENSION - Ultimate loads ($N_{Ru,m}$) and Recommended (N_{Rec})

Values for T6 installed with wood thread screws, using the maximum diameter.

Anchor size	Ø screw (mm) dv	Concrete C20/25		Hollow concrete block		Solid brick		Hollow masonry brick		Aerated concrete		Plasterboard single-wall 13 mm		Plasterboard double-wall 13+13 mm	
		kN (1 kN ≈ 100 Kg)(mm)													
		$N_{Ru,m}$	N_{Rec}	$N_{Ru,m}$	N_{Rec}	$N_{Ru,m}$	N_{Rec}	$N_{Ru,m}$	N_{Rec}	$N_{Ru,m}$	N_{Rec}	$N_{Ru,m}$	N_{Rec}	$N_{Ru,m}$	N_{Rec}
5x25	4	3,0	0,60	2,4	0,48	2,6	0,52	1,4	0,28	0,4	0,08	-	-	-	-
6x30	5	3,3	0,66	2,5	0,50	3,0	0,60	2,1	0,42	0,4	0,08	-	-	-	-
6x45	5	3,7	0,74	2,6	0,52	3,1	0,62	2,1	0,42	-	-	-	-	0,9	0,18
8x40	6	5,2	1,04	3,2	0,64	4,5	0,90	2,5	0,50	0,8	0,15	-	-	-	-
8x50	6	8,0	1,60	3,2	0,64	5,0	1,00	2,5	0,50	-	-	0,8	0,15	1,4	0,28
10x50	8	7,5	1,50	4,0	0,80	5,2	1,04	2,5	0,50	1,5	0,30	-	-	-	-
10x60	8	9,0	1,80	4,0	0,80	5,6	1,12	2,5	0,50	-	-	0,8	0,15	1,4	0,28
12x60	10	11,0	2,20	5,2	1,03	-	-	-	-	1,8	0,35	-	-	-	-
14x70	12	16,0	3,20	5,4	1,08	-	-	-	-	2,0	0,40	-	-	-	-

Values for T6 installed with the screws provided in the combo packs

Anchor size	Ø screw (mm) dv x Lv	Concrete C20/25		Hollow concrete block		Solid brick		Hollow masonry brick	
		kN (1 kN ≈ 100 Kg)(mm)							
		$N_{Ru,m}$	N_{Rec}	$N_{Ru,m}$	N_{Rec}	$N_{Ru,m}$	N_{Rec}	$N_{Ru,m}$	N_{Rec}
5x25	4	1,4	0,28	1,2	0,23	1,0	0,20	0,9	0,17
6x30	4,5	1,4	0,28	1,5	0,30	1,3	0,26	1,0	0,19
8x40	5	2,5	0,50	2,2	0,43	1,8	0,35	1,2	0,23
10x50	6	3,5	0,70	2,3	0,46	3,0	0,60	1,3	0,25
12x60	8	7,5	1,50	2,6	0,52	4,0	0,80	1,5	0,30
14x70	10	10,5	2,10	2,8	0,56	4,5	0,90	1,8	0,36

How to use and warnings

In solid materials, the screw insertion immediately produces expansion and resistance. In hollow materials, the tightening of the screw produces the perfect knotting of the expansion body, in relation to the internal geometry of the masonry.

About insertion and pass-through installation:

The anchor can be inserted with the screw already lightly screwed into the expansion body, lightly tapping its head.

It's possible using T6 in pass-through way with thanks to the flexibility of the collar.

It is recommended to use the pass-through method exclusively for thin elements to be fixed and always inserting the anchor fully into the support material.

Items not included

The anchor can be supplied in special packaging, not included in this datasheet. In any case, this datasheet is valid for all Elematic T6 versions, so body only or supplied with screw of the models described.