

# ORION V B

Part number 3105442

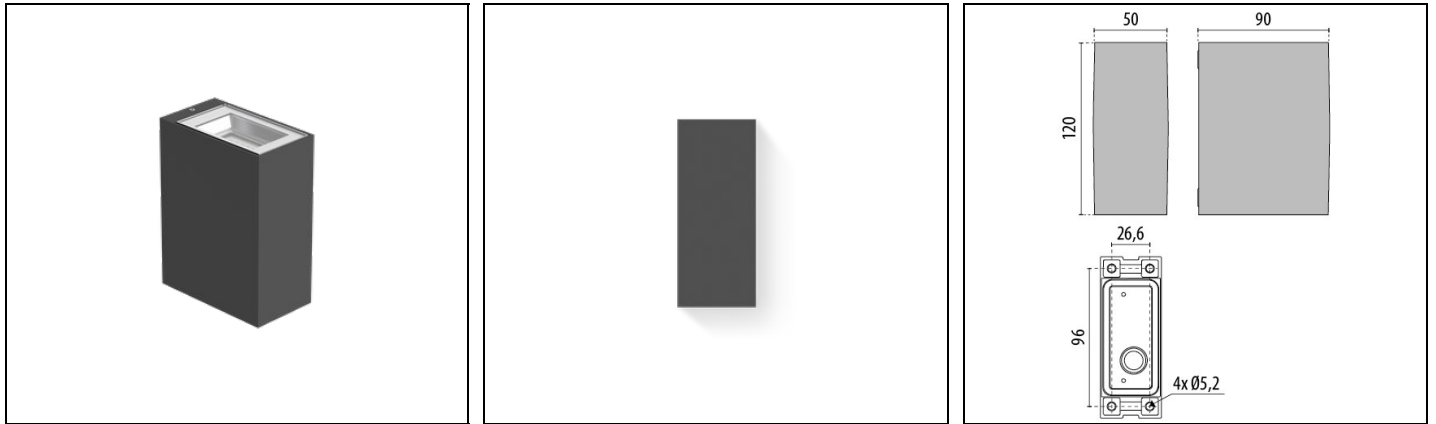

## Description

Wall-mounted LED luminaire, comprising:

- Polyester powder coat finish, die-cast aluminium housing, in compact size
- Extra-clear, toughened, flat glass diffuser, silk-screened on the inside
- Aluminium reflector
- Anti-ageing custom moulded silicone sealing gasket(s)
- Driver On Board 220-240V 50/60Hz LED module protected against surges up to 1 kV
- Stainless steel locking hardware

## Product data

ETIM Group:	EG000027	ETIM Class:	EC002892
-------------	----------	-------------	----------

## General information

Lampholder:	LED	Light source:	LED
Lightsource lumen output [lm]:	1350	Luminaire lumen output [lm]:	1065.05
Luminaire wattage [W]:	10 W	Luminous efficacy [lm/W]:	107
CRI:	80	Colour temperature [K]:	3000
Colour / Finishing:	AN-g6 / Anthracite gray / Textured	IP degree of protection:	IP65
IK-J-xxIP:	IK06 1J xx3	Protection class:	I
Optic:	S/EW - Symmetric Extra-Wide	Net weight [kg]:	0.752
Overall length [mm]:	50	Overall width [mm]:	90
Overall height [mm]:	120		

## Mechanical features

Shape:	Rectangular	Housing material:	Aluminium
Diffuser material:	Glass		

## Electrical features

Voltage type:	AC	Input voltage [V AC]:	220/240
Input frequency [Hz]:	50/60	Power factor / COS $\Phi$ :	>0.9
Inrush current [A/ $\mu$ s]:	3 / 136	C10 1.5 mm <sup>2</sup> :	66
C16 2.5 mm <sup>2</sup> :	86	B10 1.5 mm <sup>2</sup> :	41
B16 2.5 mm <sup>2</sup> :	66		

## Installation

Application area:	Outdoor	Mounting type:	Wall surface
Min. ambient temperature [°C]:	-20	Max. ambient temperature [°C]:	40

## Light features

MacAdam:	3	Lumen maintenance:	L80B10@6680oh
Distribution of light emission:	Direct/Indirect		

## Photometric data

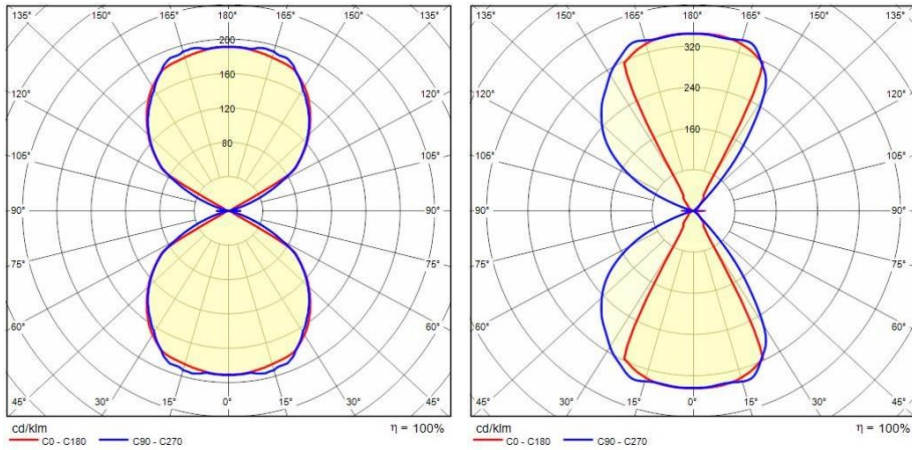

## Optional accessories

## ORION V

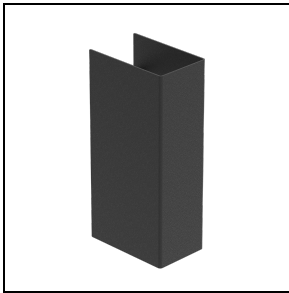
**3106287**

Carter ORION V

■ BK-81 / Black

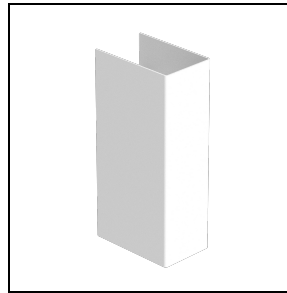
**3106286**

Carter ORION V

□ WH-87 / White

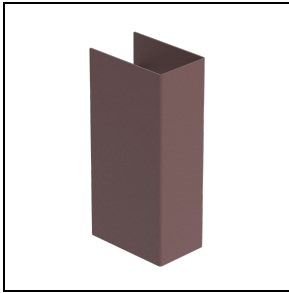
**3106288**

Carter ORION V

■ RB-10 / Rust